

WINPLUS®

LED FOLDING WORKLIGHT™

LED LIGHT POWERSTRIP USB CHARGING

ITM. / ART. 689211
Model: LM55812

CARE & USE INSTRUCTIONS

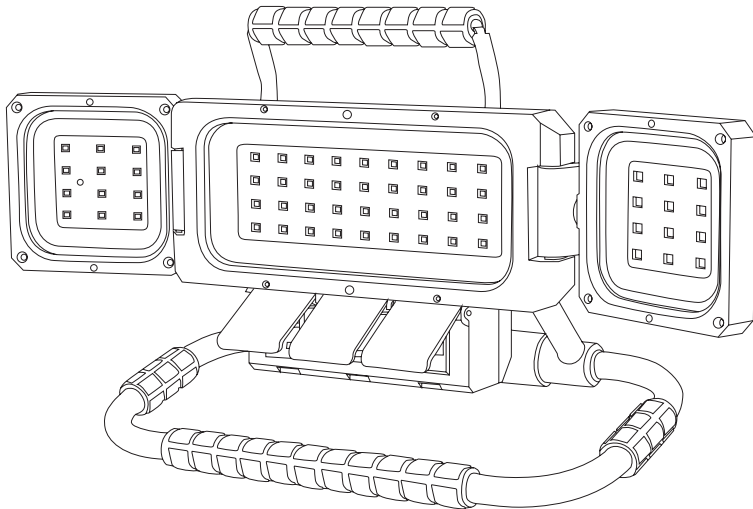

IMPORTANT, RETAIN FOR FUTURE REFERENCE: READ CAREFULLY

For assistance with assembly or installation, parts and customer service, call us at 1-866-294-9244 (English),
Mon to Fri 8 AM to 5 PM Pacific Time, email us at info@winplususa.com

820 South Wanamaker Ave., Ontario, CA 91761, USA

www.winplus.com

Important Safety Instructions:

Read this manual thoroughly before first use and keep it in a safe place for future reference. To reduce risk of fire, electric shock, or injury to persons:

- Important: For indoor and dry location use only.
- Improperly connecting the grounding wire can result in the risk of electric shock. Do not modify the power cord plug provided with the product. Never remove the grounding prong from the plug.
- Do not plug into another power bar or extension cord.
- Do not use the product if the power cord or plug is damaged. If damaged, have it repaired by a service facility before use. If the plug does not fit the outlet, have a proper outlet installed by a qualified electrician.
- Do not abuse the power cord. Never use the power cord to carry the product or pull the plug from an outlet. Keep the power cord away from heat, oil, sharp edges, or moving parts.
- Do not look directly into the LEDs when operating.
- Keep away from liquids, oils, petrol, and all chemicals.
- This is not a toy and keep away from children.
- Turn off and unplug from outlet when not in use.
- Keep proper balance and footing at all times. Do not overreach the product.
- Save these instructions.

CAUTION: Risk of Electric Shock. Do not use in or near wet locations such as kitchens or baths.

CAUTION: Risk of Electric Fire. Do not charge electrical devices while stowed in storage compartment.

Warning:

- LED light output is strong enough to injure human eyes. Precautions must be taken to prevent looking directly at the LED for more than a few seconds.
- If the product is damaged, it shall be exclusively replaced by the manufacturer or the service agent or qualified person in order to avoid a hazard.
- The warnings, precautions, and instructions discussed in this manual cannot cover all possible conditions and situations that may occur. The operator must understand that common sense and caution are factors which cannot be built into this product, but must be supplied by the operator.

Package Contains:

Please layout all parts prior to installation. Read instructions prior to installation.

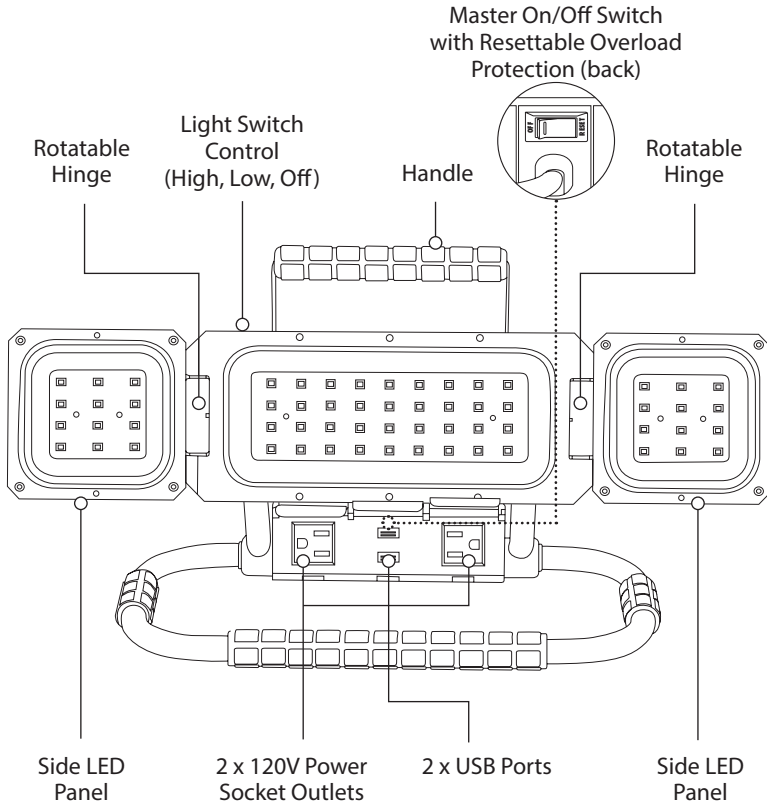

Product Overview:

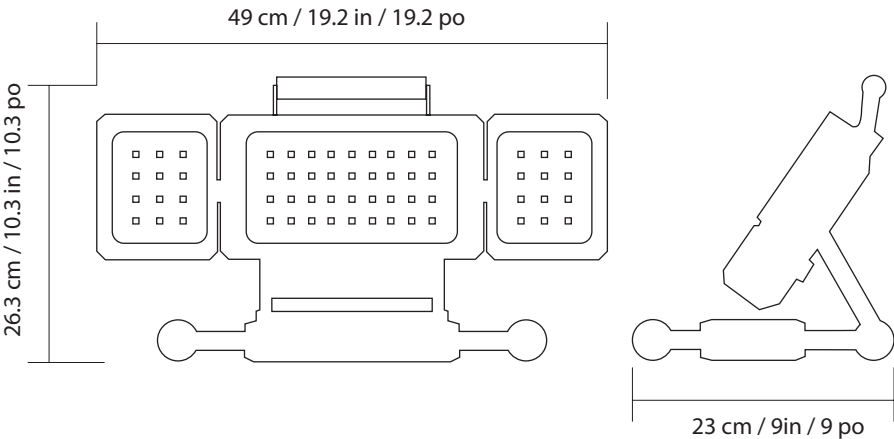

Technical Specifications:

- Input Voltage and Current: 120 Vac, 60 Hz, 11 A
- Maximum Wattage: 1200 W
- Power Sockets: 120 V, 10 A max
- USB Ports: 5V, total combined 3.1A max
- Light Output: 2100 Lumens
- LED Wattage: 25 W
- Color Temperature: 5000K
- Product Weight: 2.36 kg / 5.2 lb
- Power Cord Length: 1.8 m / 6 ft



This product is ETL/cETL Listed

Instructions:

Using the worklight:

1. Before plugging in the worklight, unfold it with the handle on top.

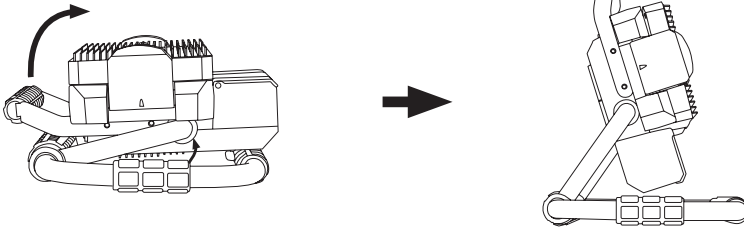

2. Unfold both Side LED Panels.

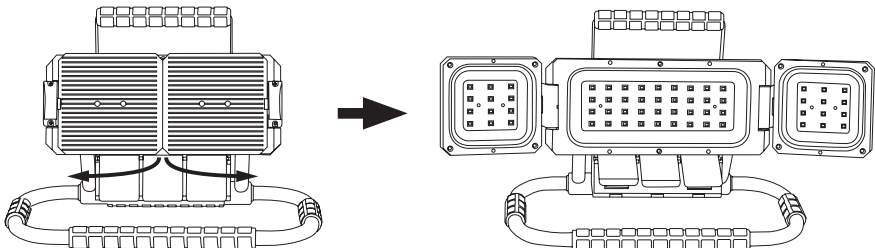

3. Plug in the Worklight to main socket, and turn on the master switch at back.
4. Turn on the light switch. You can control the light by switching to HI (I), LOW (II), or OFF (O) setting.

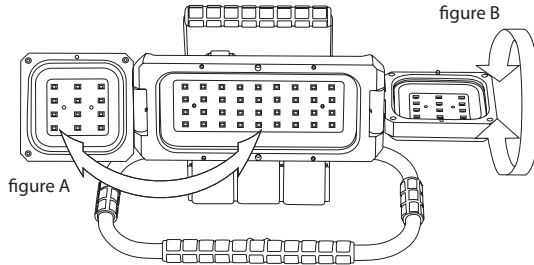

NOTE: The Side LED Panel can be rotated horizontally (figure A). After expanding the panel, it can be rotated vertically (figure B). Be noted that the maximum horizontal rotation angle is 180° , and the maximum vertical rotation angle is about 340° (turn 170° back and turn 170° front when the LED Panel is fully opened). Do not over-rotate the hinge as it would damage the worklight.

Using the socket outlets and USB ports:

1. Make sure your device has been turned off before plugging to Folding Worklight sockets / USB ports.
2. Plug in the Worklight to main socket, and turn on the master switch at back.
3. Plug your device into the Folding Worklight socket / USB port.
4. When you have finished using the device, turn off your device and unplug it from Folding Worklight.

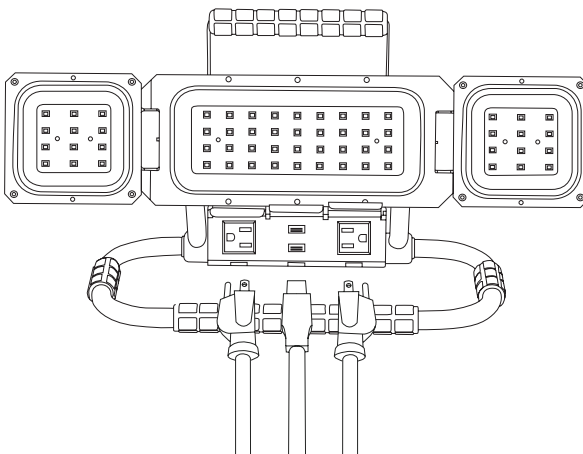

Hanging on the wall:

You can use the worklight by hanging on the wall. Expand the worklight by rotating the base 180° (like below) and hang on the screw with the base.

NOTE: Please find an appropriate mounting surface and mounting means (not included), which is suitable for the weight of folding worklight.

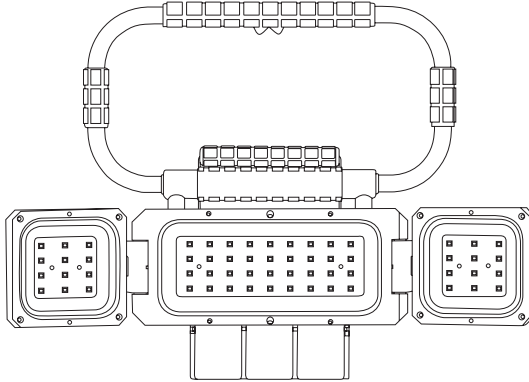

Maintenance:

Cleaning instructions: When cleaning, make sure you have unplugged the worklight and allow it to cool to room temperature. Do not open the power socket covers when cleaning. The worklight can be cleaned with a feather duster or a soft damp cloth. You should plug in the worklight after it has been completely dried.

Troubleshooting:

1. The LED Light cannot be switched on.

Solution: Please ensure the plug is connected to main socket. Check if the master switch is ON and the light switch in High or Low setting

2. USB plug / Socket does not function.

Solution: Please ensure the plug is connected to main socket and master switch is ON.

3. The Worklight is turned off automatically.

Solution: The sockets may be overloaded. Please unplug from or turn off the main switch. Then unplug all products from the sockets of Worklight. Wait for about 10 minutes. Then turn on the master switch (switch to 'RESET') at back.

Warranty:

Winplus North America

Limited warranty

This Winplus product carries a 1 year warranty against defects in workmanship and materials. This product is not guaranteed against wear or breakage due to misuse and/or abuse.

NOTE: Warranty only applies for North American customers of purchases made in North America.

Conditions of Warranty

If during the 1 year warranty period your new product is found to be defective, Winplus North America will repair such defect, or replace the product, without charge for parts or labor subject to the following conditions:

- All repairs must be performed by Winplus North America.
- All warranty claims must be accompanied by a copy of the sales receipt or bill of sale.
- The equipment must not have been altered or damaged through negligence, accident, improper operation, or failure to follow the product instructions for installation, use, or care.
- The replacement of parts is excluded from the warranty when replacement is necessary due to normal wear and tear.
- Repair or replacement parts supplied by Winplus North America under this warranty are protected only for the unexpired portion of the original warranty.
- This is a "repair or replace" warranty only, and does not cover the costs incurred for the installation, removal or reinstallation of the product.

OWNER'S RESPONSIBILITIES: Winplus North America will make every effort to provide warranty service within a reasonable period of time. SHOULD YOU HAVE ANY QUESTIONS ABOUT SERVICE RECEIVED OR IF YOU WOULD LIKE ASSISTANCE IN OBTAINING SERVICE, PLEASE CALL TOLL FREE 1.866.294.9244 DURING REGULAR BUSINESS HOURS MONDAY THROUGH FRIDAY 9:00 AM TO 5:00PM.

NOTE: Toll Free # is for North America Customers ONLY. See Customer service section for customer contact numbers for other regions/offices.

For customer service and technical support, please call us at 1.866.294.9244 or email us at customercare@winplususa.com. If at that time it is determined that a replacement unit is needed, the support representative will issue a Return Authorization and instruct on how to get a new unit.

Winplus North America makes no other warranty of any kind aside from the limited express warranty stated herein.

DISCLAIMER OF WARRANTIES, INCLUDING WARRANTY OF MERCHANTABILITY AND WARRANTY OF FITNESS FOR PARTICULAR PURPOSE: EXCEPT AS SPECIFICALLY SET FORTH HEREIN, NO WARRANTY OR REPRESENTATION, EXPRESS OR IMPLIED, IS MADE AS TO THE LED FOLDING WORKLIGHT. EXCEPT AS EXPRESSLY SET FORTH HEREIN, WINPLUS NORTH AMERICA AND/ OR ITS AFFILIATES EXPRESSLY DISCLAIMS, WITHOUT LIMITATION, ANY STATUTORY WARRANTIES AND ALL IMPLIED WARRANTIES, INCLUDING ANY IMPLIED WARRANTY OF MERCHANTABILITY OR FITNESS FOR A PARTICULAR PURPOSE.

FCC / IC Compliance Statement:

This device complies with Part 15 of the FCC rules. Operation is subject to the following two conditions: (1) this device may not cause harmful interference, and (2) this device must accept any interference received, including interference that may cause undesired operation.

Warning: Changes or modifications to this unit not expressly approved by the party responsible for compliance could void the user's authority to operate the equipment.

The manufacturer is not responsible for any radio or TV interference caused by unauthorized modifications or change to this equipment. Such modifications or change could void the user's authority to operate the equipment.

This equipment has been tested and found to comply with the limits for a Class B digital device, pursuant to part 15 of the FCC Rules. These limits are designed to provide reasonable protection against harmful interference in a residential installation. This equipment generates, uses and can radiate radio frequency energy and, if not installed and used in accordance with the instructions, may cause harmful interference to radio communications. However, there is no guarantee that interference will not occur in a particular installation. If this equipment does cause harmful interference to radio or television reception, which can be determined by turning the equipment off and on, the user is encouraged to try to correct the interference by one or more of the following measures:

- Reorient or relocate the receiving antenna.
- Increase the separation between the equipment and receiver.
- Connect the equipment into an outlet on a circuit different from that to which the receiver is connected.
- Consult the dealer or an experienced radio/TV technician for help.

CAN ICES-0005 (B) / NMB-0005 (B)

 Have a comment or question? Email us at customer@winplususa.com or visit us online at www.winplus.com

WINPLUS[®]

820 South Wanamaker Ave., Ontario, CA 91761, USA | Tel: 1-866-294-9244

© 2016 Winplus North America Inc. All rights reserved.